

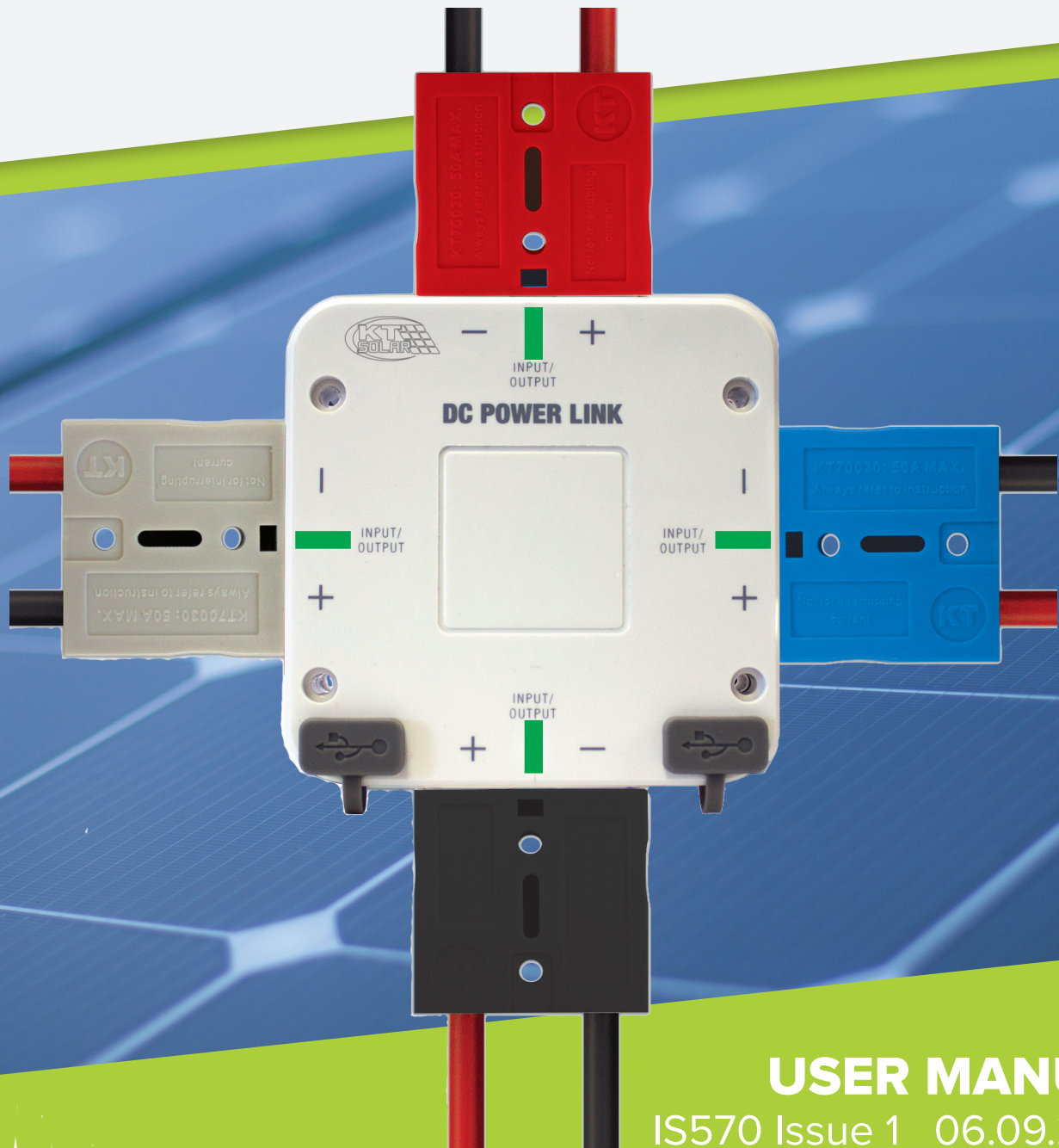

DC POWER LINK

30A 12-24V

Model No. KT70704



USER MANUAL

IS570 Issue 1 06.09.2023

Please refer to this user manual before using or installing this product.

FEATURES

1. Dustproof Cover
2. 50A Heavy Duty Connector Input/Output
3. Mounting Holes
4. USB Outputs

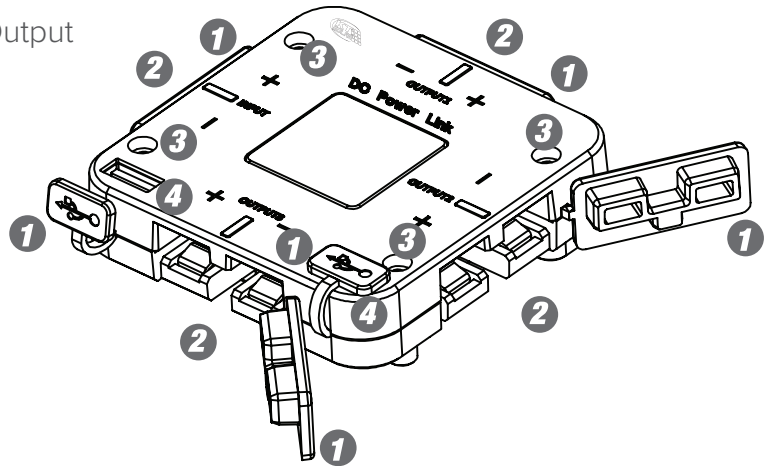

Suitable for use with 50A Heavy Duty Connectors (Grey/Black/Red/Blue)

SPECIFICATIONS

- Suitable for 12-24V DC operations.
- LED indicator to show live circuit once input has been connected.
- 4 mounting points allow easy and secure mounting (Stainless steel hardware included).
- Dustproof & splashproof.
- Housing manufactured from durable UV Stabilised Polycarbonate & ABS.
- Dimensions (mm): 86 (L) x 86 (W) x 22 (H).
- Connects with 50A heavy duty connectors (Grey/Black/Red/Blue).
- Single input rated to 30A draw.
- Each output rated to 15A (30A Total).
- 2.1A & 1A USB outputs (3.1A Max).

IMPORTANT INFORMATION:

Not suitable for mounting in vehicle engine bays.



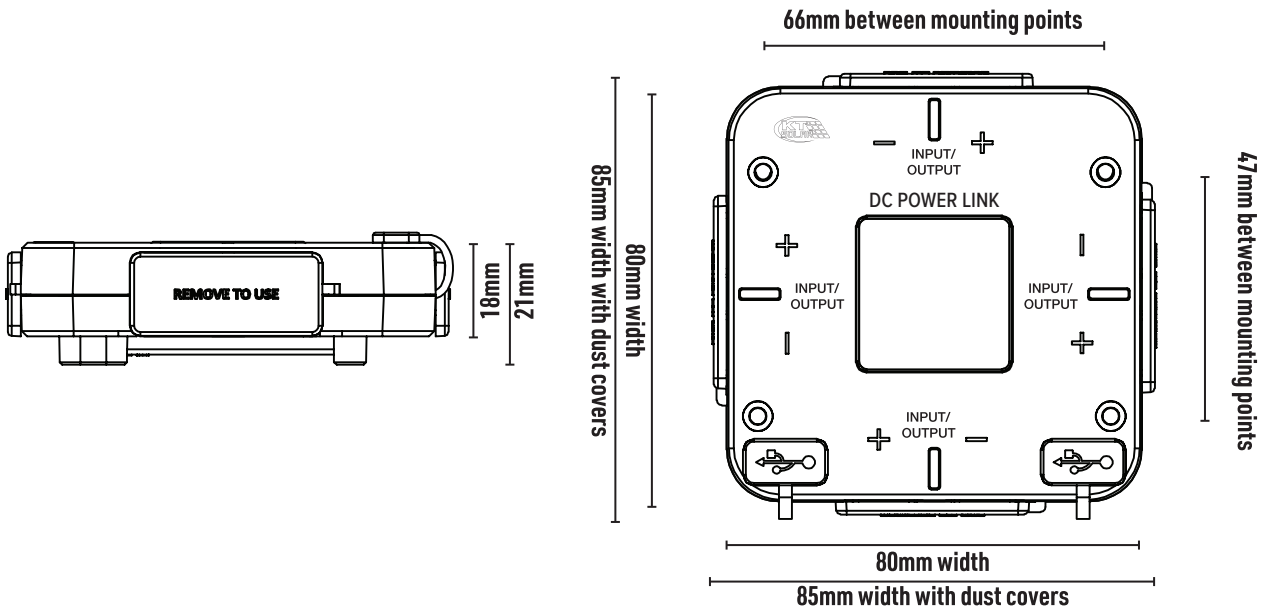

OPERATION INSTRUCTIONS

- Remove the dustproof cover from desired 'Input / Output' socket and connect device via 50A Heavy Duty Connector. (15A Max per Output, 30A Total).
- Once 'input' is connected, DC Power Link is 'live'. LEDs will indicate 'live' power to circuits.
- To connect a 2.1A / 1A USB device, remove the dustproof cover and connect device at any time. (Max total USB rating 3.1A).
- Multi use configuration of Input or Output. Sockets are omnidirectional and can connect as many inputs (Max 3) or outputs (Max 3) as required.

CONFIGURATION 1

1x 12/24V Battery Source (Input)
3x 12/24V Devices (Output)

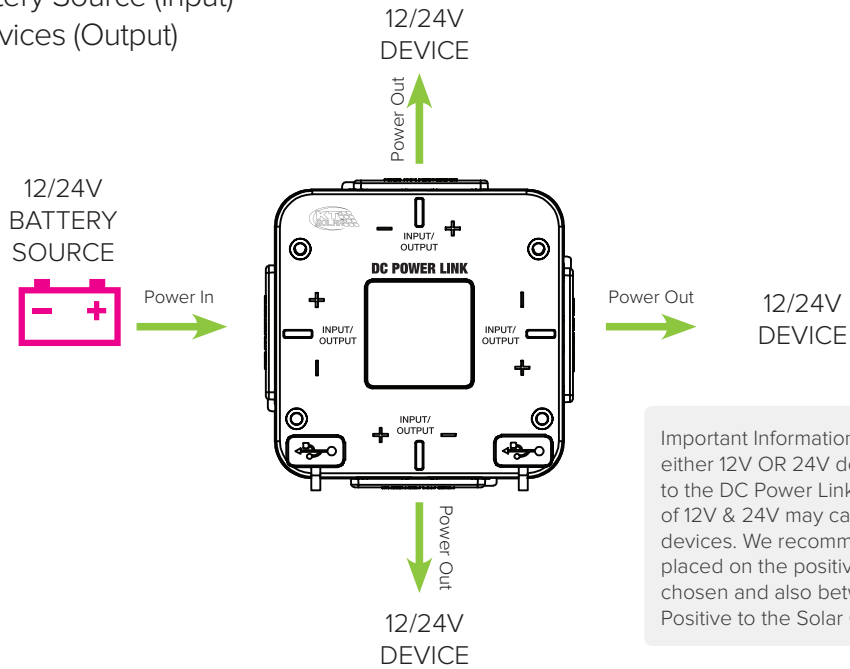

Important Information: Please ensure that either 12V OR 24V devices are connected to the DC Power Link. Using a combination of 12V & 24V may cause damage to your devices. We recommend suitable fuses are placed on the positive cable to devices chosen and also between Solar Panel Positive to the Solar Controller selected.

CONFIGURATION 2

2x 12/24V Battery Source (Input)
2x 12/24V Devices (Output)

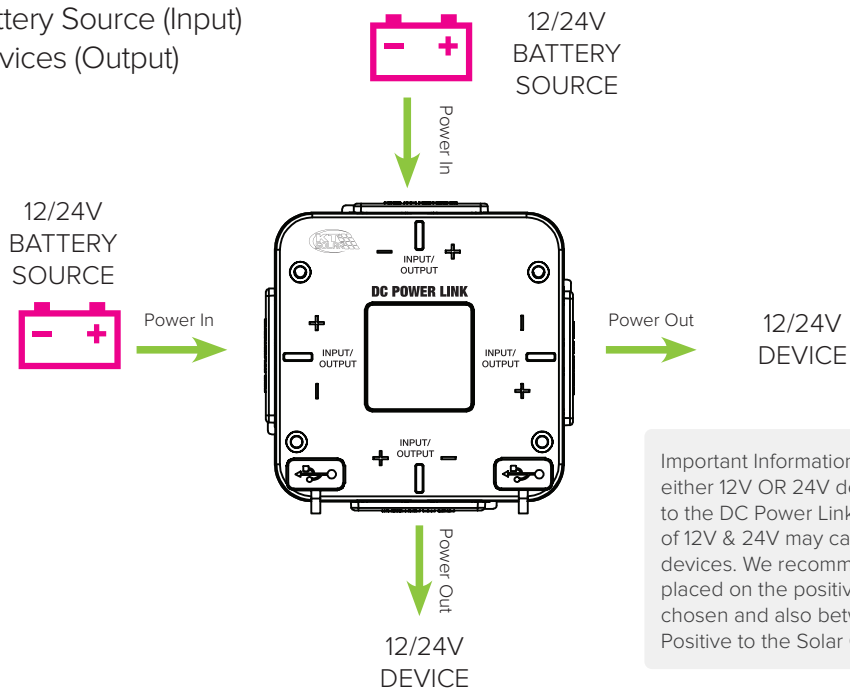

Important Information: Please ensure that either 12V OR 24V devices are connected to the DC Power Link. Using a combination of 12V & 24V may cause damage to your devices. We recommend suitable fuses are placed on the positive cable to devices chosen and also between Solar Panel Positive to the Solar Controller selected.

CONFIGURATION 3

3x 12/24V Battery Source (Input)
1x 12/24V Devices (Output)

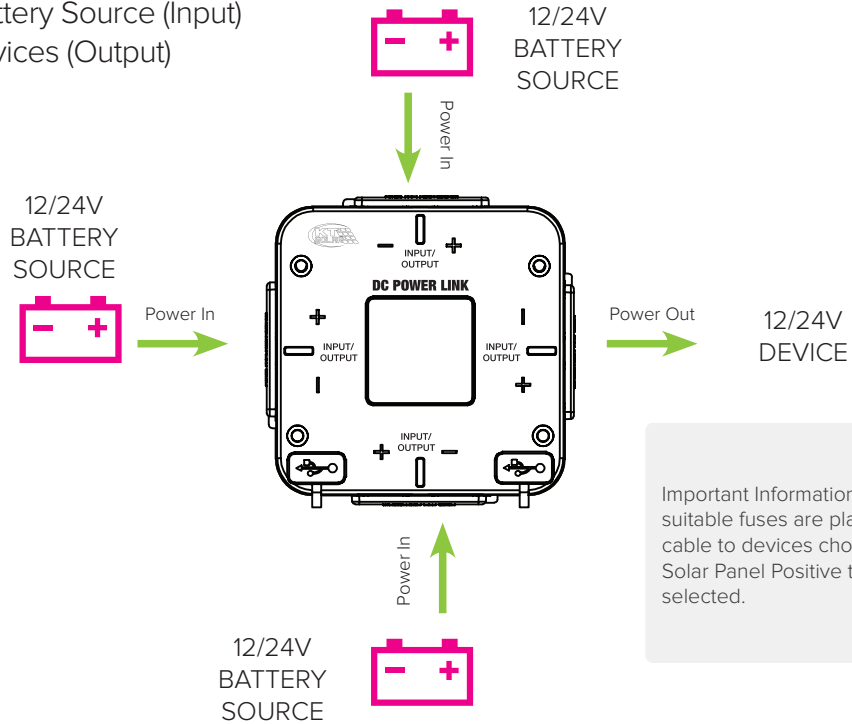

Important Information: We recommend suitable fuses are placed on the positive cable to devices chosen and also between Solar Panel Positive to the Solar Controller selected.

CONFIGURATION 4

1x 12V Battery Source (Input)
1x 12V Regulated Power Source (Input)
1x 12V Devices (Output)

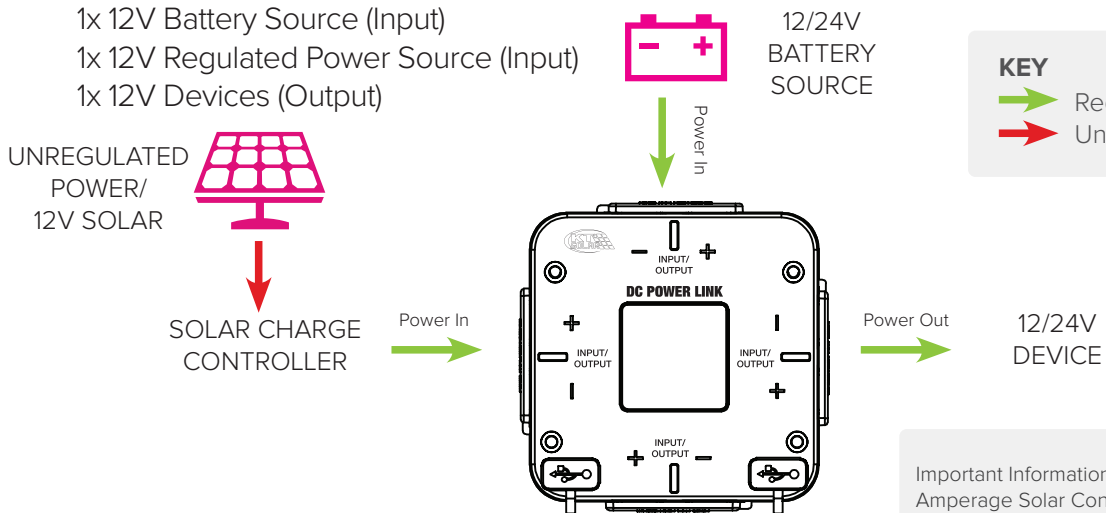

KEY

- Regulated Power
- Unregulated Power

Important Information: Select suitable Amperage Solar Controller based on your single 12V Solar Panel. We recommend suitable fuses are placed on the positive cable to devices chosen and also between Solar Panel Positive to the Solar Controller selected.

CONFIGURATION 5

3x Solar Source (Input)
1x Solar Regulator to Battery (Output)

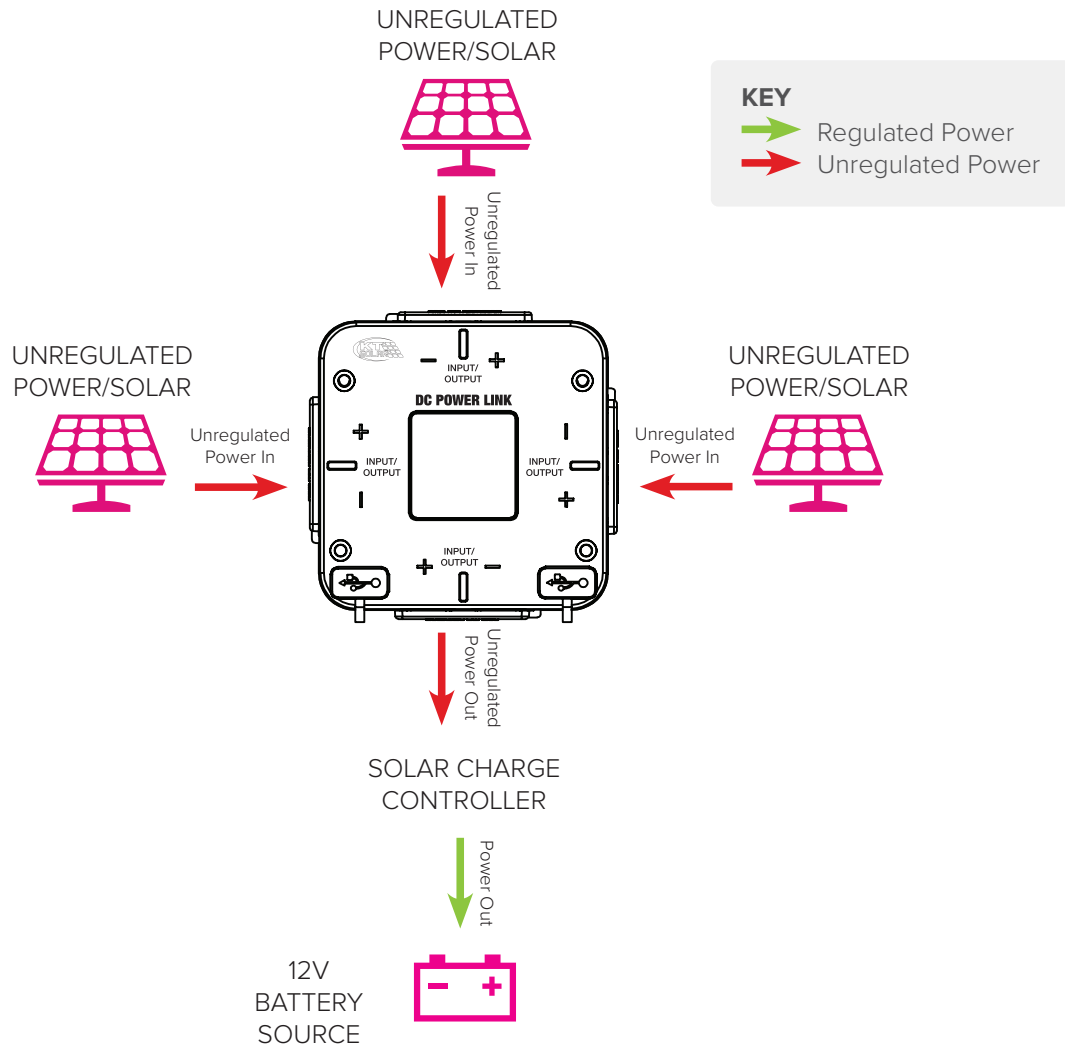

Tip: As you are fitting 3 panels in parallel configuration, the Amperages are therefore tripled. If fitting 2 panels, the Amperages are doubled. Select the correct Solar Charge Controller Amperage. We recommend suitable fuses are placed on the positive cable to devices chosen and also between Solar Panel Positive to the Solar Controller selected.

Recommended Suggestion: If fitting multiple 12V Solar Panels, always select Panels of the same wattage & brand.

Important Information: Please follow normal 12/24V operational procedures when using the DC Power Link. To avoid overloading your devices and to prevent damage, please ensure that only REGULATED power is fed into your devices. The DC Power Link does not act as a Solar Regulator.

CONFIGURATION 6

1x 12V Battery Source (Input)
 1x Unregulated Power Source converted to regulated power using a Solar Regulator which is then fed into the DC Power Link (Input)
 2x 12V Devices (Output)

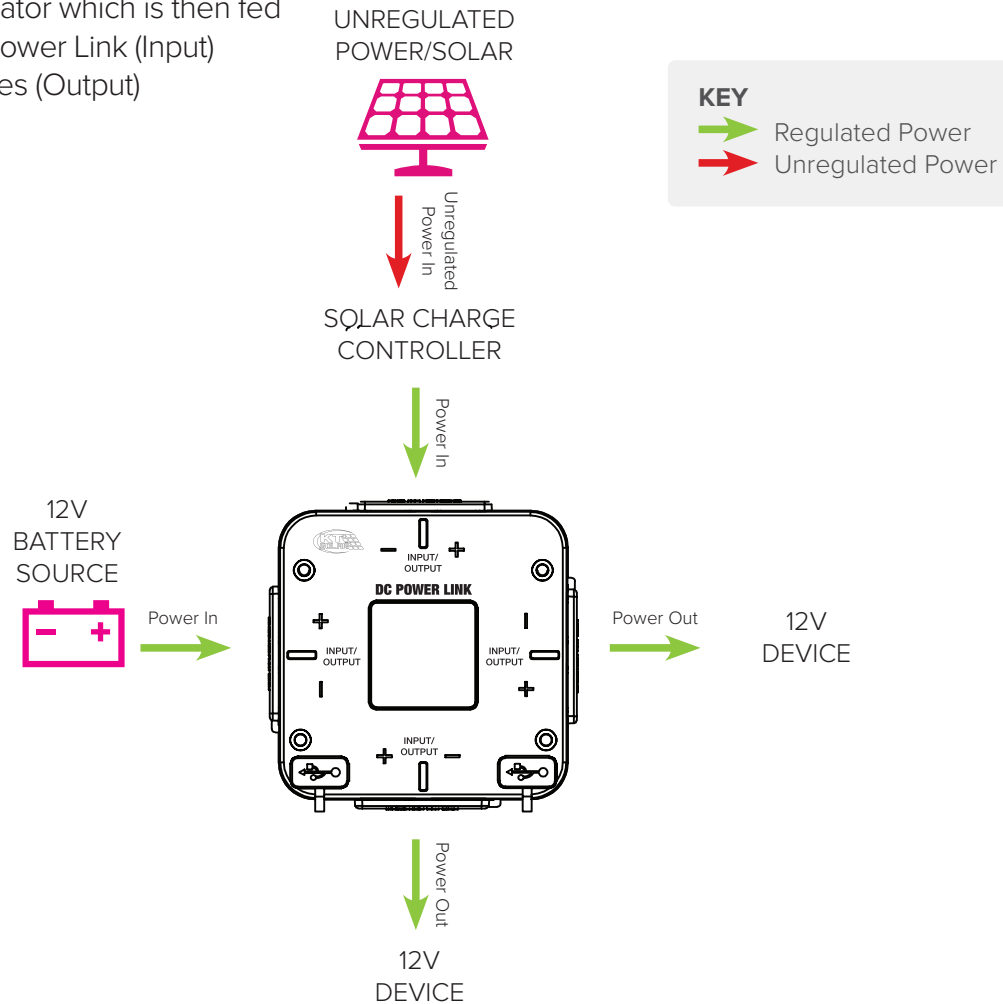

Recommended Suggestions: Selected suitable Amperage Solar Controller based on your single 12V Solar Panel. It is recommended that suitable fuses are placed on the positive cable to devices chosen and also between Solar Panel Positive to the Solar Controller selected.

Important Information: Please follow normal 12/24V operational procedures when using the DC Power Link. To avoid overloading your devices and to prevent damage, please ensure that only REGULATED power is fed into your devices. The DC Power Link does not act as a Solar Regulator.

WARRANTY STATEMENT

Brown & Watson International Pty Ltd of 1500 Ferntree Gully Road, Knoxfield, Vic. telephone (03) 9730 6000, fax (03) 9730 6050, warrants that all products described in its current catalogue (save and except for all bulbs and lenses whether made of glass or some other substance) will under normal use and service be free of failures in material and workmanship for a period of one (1) year (unless this period has been extended as indicated elsewhere) from the date of the original purchase by the consumer as marked on the invoice. This warranty does not cover ordinary wear and tear, abuse, alteration of products or damage caused by the consumer.

To make a warranty claim the consumer must deliver the product at their cost to the original place of purchase or to any other place which may be nominated by either BWI or the retailer from where the product was bought in order that a warranty assessment may be performed. The consumer must also deliver the original invoice evidencing the date and place of purchase together with an explanation in writing as to the nature of the claim. In the event that the claim is determined to be for a minor failure of the product then BWI reserves the right to repair or replace it at its discretion. In the event that a major failure is determined the consumer will be entitled to a replacement or a refund as well as compensation for any other reasonably foreseeable loss or damage. This warranty is in addition to any other rights or remedies that the consumer may have under State or Federal legislation.

IMPORTANT NOTE

Our goods come with guarantees that cannot be excluded under the Australian Consumer Law. You are entitled to a replacement or refund for a major failure and compensation for any other reasonably foreseeable loss or damage. You are also entitled to have the goods repaired or replaced if the goods fail to be of acceptable quality and the failure does not amount to a major failure.

Distributed by:

AUSTRALIA

Brown & Watson International Pty Ltd
Knoxfield Victoria 3180
Phone: (03) 9730 6000
Fax: (03) 9730 6050
National Toll Free: 1800 113 443

NEW ZEALAND OFFICE

Brown & Watson International Pty Ltd
19 Bell Avenue,
Mount Wellington,
Auckland 1060, New Zealand
Phone: (09) 525 4575